



Interim Report

Name and location of the Veterinary Education Establishment (VEE)

Faculty of Veterinary Medicine – VMF, University of Leipzig, Leipzig, Germany.
An den Tierkliniken 19, 04103 Leipzig

Name and details of the current VEE's Head

Prof. Dr. Dr. Thomas Vahlenkamp, Head of the Institute of Virology, An den Tierkliniken 29,
04103 Leipzig, Fon: +493419738201, E-Mail: vahlenkamp@vetmed.uni-leipzig.de

Date of the completion of the Interim Report *(3.5 years after the (full) Visitation at the latest):*

April 27, 2022

Date of the previous Visitation

October 15 – 19, 2018

Any major changes which may affect the compliance with the ESEVT Standards since the previous SER

There are no major changes, but there are a number of positive developments, especially in relation to suggestions for improvement made by the visitation team, as well as some changes in the legislation with relevance to education which we would like to briefly list.

Finances: With regard to the very tight financial situation of the faculty, a small-scale improvement has come about. Since the previous visitation, target agreements of our faculty with the University have been fully established. In fulfilling these targets, the faculty receives a 10% bonus of the annual budget allocation. The bonus is allocated to the faculty at the end of the target agreement term and can be spent over a 3-year-period. For the 2019-2020 target agreement, the faculty was allocated a bonus of EUR 47,000. **Curriculum:** The very extensive reductions and partial elimination of face-to-face teaching during the Corona pandemic were largely compensated for by digital teaching and learning formats. Teaching in the clinical rotations was maintained throughout. Substantial investments were made in the area of digital infrastructure at University and Faculty level in order to reduce the impending teaching deficits during the Corona pandemic to a minimum. The last fundamental amendment of the TAppV was in December 2016. In December 2019, the first amendment to the Examination Regulations for the Veterinary Medicine degree program was published, in which the implementation of electronic examinations/sub-examinations was introduced for the disciplines zoology, botany, clinical propaedeutics, radiology, virology, pharmacology and toxicology, milk hygiene and food science including meat hygiene. These exams are now created using the UCAN exam platform and are offered in a tablet-based format.

Developments at PAUL Centre of Applied Training and Learning Oct. 2018-2022: PAUL has been increasingly integrated into the preclinical elective section in recent semesters. Up to 60 workstations are

available for the students now. A honeybee station for practising the basic tasks at an apiary, an escape room for microbiology practice as well as stations for x-ray in horses and pharmacological prescribing and dosing training have been integrated. Covid-19-pandemics forced a stronger connection between the five German veterinary skills labs. Together, the project “Vet Skills Lab Challenge” was developed in 2020 to enhance the students practical work during home office and to motivate them for skills training and model building. In 2021, the Vet Skills Lab Challenge was implemented as a compulsory elective course across all German veterinary skills labs. Students from different semesters and different locations, as a team, had to solve case scenarios with practical tasks at home and share them on an online platform. The result was presented at the Conference of Veterinary Education in Surrey 2021 and honoured with a poster prize. In spring 2022 a permanent position was implemented by the faculty to manage and further develop PAUL. With one half-time permanent research assistant, 4 senior and 3 junior students PAUL will continue into summer semester 2022.

Introduction of a Ph.D. degree program is under discussion at the VMF: In February 2020 a structured postgraduate program (“Vet-spA”) had been implemented at the faculty and started with a variety of training courses offered by staff of the VMF primarily for doctoral students. This adds significantly to broaden the theoretical and practical research training beyond their main dissertation subject and should support applications for temporary Ph.D. programs funded by the German Research Council (DFG). **Description of new legal constraints imposed on the curriculum by national/regional legislations:** The revision of the regulations within the Animal Welfare - Farm Animal Husbandry Ordinance (Tierschutz-Nutztier-haltungs-Verordnung) as well as the new European legislation of the harmonized Animal Disease Control, the Regulation (EU) 2016/429 of the European Parliament and of the Council of 9 March 2016 on transmissible animal diseases and amending and repealing certain acts in the area of animal health (‘Animal Health Law’) had to be included into the curricula of animal husbandry, animal welfare and animal disease control.

Changes in legislation at national level: Tier-LMHV: § 12a omitted. Tier-LMÜV: new § 2a introduced. With entry into force of Commission Delegated Regulation (EU) 2019/624 ante-mortem inspections outside the slaughterhouse in case of emergency slaughter is only allowed by the official veterinarian. Zoonosen-Überwachungsverordnung. AVV LmH: Changes in § 2 (approval or authorization of establishments), § 10 (laboratory tests) with annexes and deletion of § 8 (recording and reporting of examination results for fattening pigs). European level: VO (EG) Nr. 854/2004: repealed. Its contents are continued by Regulation (EC) 2017/625 (Control Regulation), Delegated Regulation (EU) 2019/624 and Implementing Regulation (EU) 2019/627. Expansion of mobile slaughter facilities by Regulation (EC) 2021/1374 amending Regulation (EC) 853/2004. Rohmilchgüte-Verordnung replaces Milchgüte-VO. Lebensmittel- und Futtermittelgesetzbuch § 11 Abs. 2. 2 a, b, c omitted (fraud). European level: Regulation (EU) 625/2017 (official controls) replaces Regulation (EC) 854/2004 and Regulation (EC) 882/2004. Regulation (EC) 2018/848 (organic production) replaces Regulation (EU) 834/2007

Progress in the correction of Minor Deficiencies (partial compliance with ESEVT Standards) and plans for the near future:

Partially compliant with ESEVT substandard 1.5 because of lack of input from stakeholders

On the part of the faculty management, the establishment of an advisory board with stakeholders from business and politics (VMF Stakeholder Advisory Committee) has been adopted and is currently under development, but not yet completely implemented. In response to the recommendations of the last visitation team, the Faculty of Veterinary Medicine (VMF) has conducted a systematic inventory of all stakeholders from all groups in society and our profession. In doing so, we found that we have a large number of external stakeholders who indeed actively or passively influence the work at our Faculty with their input, advice and support, critically reflect and provide feedback to the institutions and the Dean's Office. We are now in the process of targeting individuals from these groups and asking them to become members of an external VMF Stakeholder Advisory Committee. This process is not yet complete. We are, however, confident to assemble a Stakeholder Advisory Committee with external representative individuals from the groups that already

support us. Independent of the existence of a formal advisory board, the faculty is in regular exchange with the other veterinary medical educational institutions in the German-speaking area, the Veterinary Chamber of Saxony as well as the Federal Association of Practicing Veterinarians e.V. as well as the Federal Association of Veterinary Medicine Students e.V.. The connections to the economy and politics are to be expanded in a timely manner.

Partially compliant with ESEVT substandard 3.8 and 3.10 because of sub-optimal EPT organisation
The sub-optimal organization of the External Practical Training EPT is planned to be covered by introducing an online case log platform. This will enable feedback on the progression of students during their EPT, assessment of animal species, numbers of patients seen and overall exposure to the breadth of veterinary medicine. Assessment of the case logs will also enable a comparison with the blue print for Day One Competences.

Partially compliant with ESEVT substandard 4.7 and 4.13 because of sub-optimal biosecurity measures in some areas (entrance and exit from the necropsy room, the on-campus slaughterhouse and the small animal isolation facility)

Small animal isolation facility: The biosecurity lock of the isolation for infectious diseases has found a temporary solution. The department for Small Animals is planning a much-needed expansion of the intensive care unit, doubling the present size and establishing a separate ICU for canine and feline patient, including a new location for the isolation unit for infectious diseases.
On-campus slaughterhouse: Hygienic standards will be improved by integrating facilities for changing boots and gowns in an adjoining room of the slaughterhouse. Structural implementation is planned by the end of 2022.

Pathology: Safety and Necropsy room:

Biosafety and biosecurity measures: The current situation is due to inadequacies of the infrastructure itself. The changing room and access area to the section hall in the Veterinary Pathology Institute is being restructured. This is part of the fundamental renovation of the entire building complex of the institute. Preparatory work for this renovation is currently being carried out. Major reconstructions are in a final planning phase with realization in the nearby future. The structural redesign of the changing room and access area to the section hall as well as the renovation of the section hall itself are part of the first construction phase. The Institute of Veterinary Pathology is planned to be reconstructed in 2022-2028. Figure 1 depicts the planned necropsy area.

Expected date of the next Visitation (*which should be completed not later than 2 months before the date of the ECOVE meeting preceding the end of granted status*) April 2025

Annex: Updated Excel table with ESEVT Indicators for the last three complete academic years 2018/19, 2019/20 and 2020/21

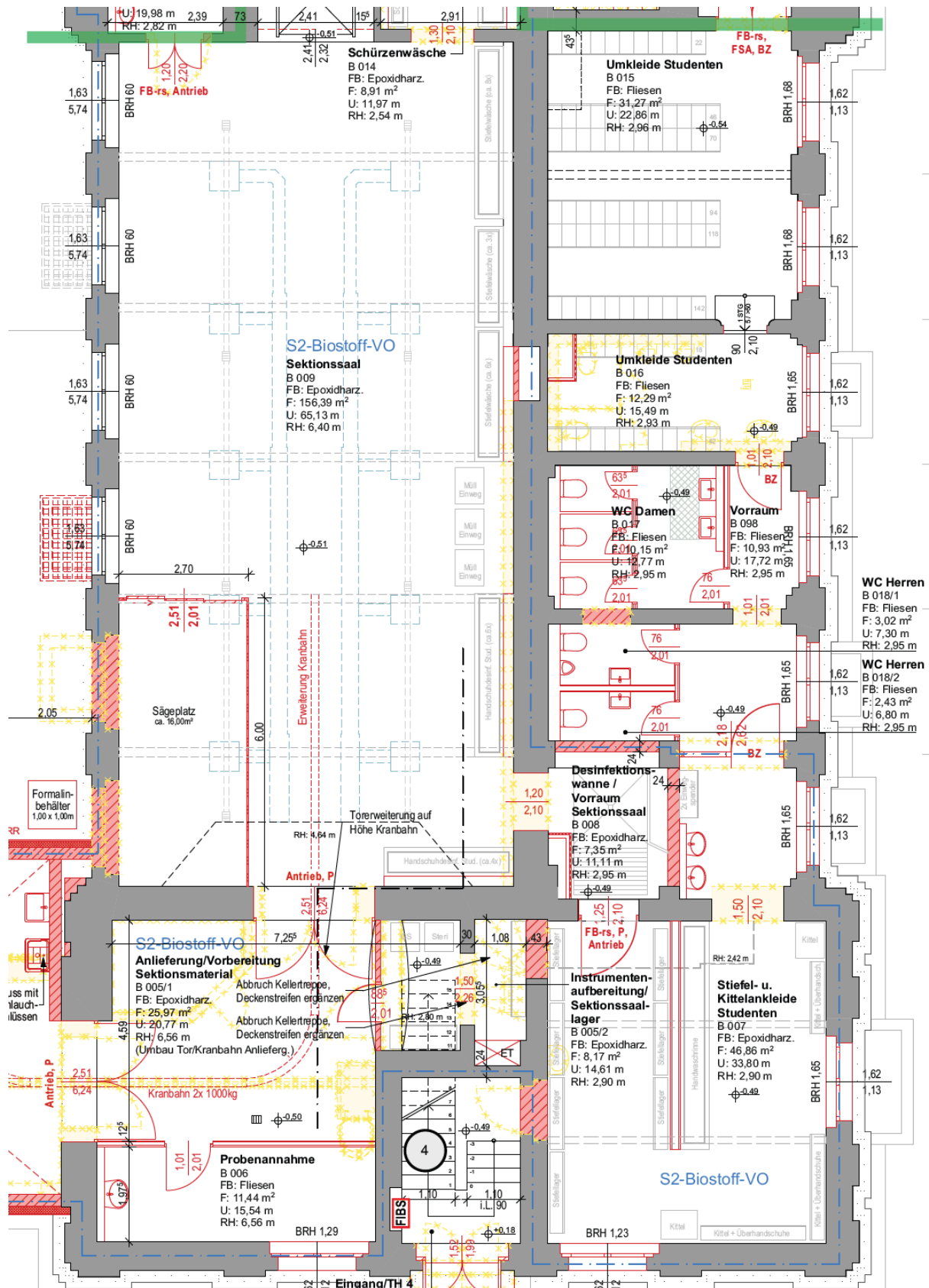



ESEVT Indicators

Name of the Establishment:		Faculty of Veterinary Medicine, University of Leipzig				
Date of the form filling:		01.04.2022				
Calculated Indicators from raw data		Establishment	Median	Minimal	Balance³	
		values	values¹	values²		
I1	n° of FTE academic staff involved in veterinary training / n° of undergraduate students	0,134	0,15	0,13	0,008	
I2	n° of FTE veterinarians involved in veterinary training / n° of students graduating annually	0,791	0,84	0,63	0,161	
I3	n° of FTE support staff involved in veterinary training / n° of students graduating annually	1,006	0,88	0,54	0,466	
I4	n° of hours of practical (non-clinical) training	680,000	953,50	700,59	-20,590	
I5	n° of hours of clinical training	857,000	941,58	704,80	152,200	
I6	n° of hours of FSQ & VPH training	440,000	293,50	191,80	248,200	
I7	n° of hours of extra-mural practical training in FSQ & VPH	250,000	75,00	31,80	218,200	
I8	n° of companion animal patients seen intra-murally / n° of students graduating annually	190,080	62,31	43,58	146,500	
I9	n° of ruminant and pig patients seen intra-murally / n° of students graduating annually	49,989	2,49	0,89	49,099	
I10	n° of equine patients seen intra-murally / n° of students graduating annually	13,908	4,16	1,53	12,378	
I11	n° of rabbit, rodent, bird and exotic seen intra-murally / n° of students graduating annually	21,989	3,11	1,16	20,829	
I12	n° of companion animal patients seen extra-murally / n° of students graduating annually	4,298	5,06	0,43	3,868	
I13	n° of individual ruminants and pig patients seen extra-murally / n° of students graduating annually	1,719	16,26	8,85	-7,131	
I14	n° of equine patients seen extra-murally / n° of students graduating annually	0,860	1,80	0,62	0,240	
I15	n° of visits to ruminant and pig herds / n° of students graduating annually	0,521	1,29	0,54	-0,019	
I16	n° of visits of poultry and farmed rabbit units / n° of students graduating annually	0,169	0,11	0,04	0,124	
I17	n° of companion animal necropsies / n° of students graduating annually	2,355	2,11	1,40	0,955	
I18	n° of ruminant and pig necropsies / n° of students graduating annually	1,613	1,36	0,90	0,713	
I19	n° of equine necropsies / n° of students graduating annually	0,450	0,18	0,10	0,350	
I20	n° of rabbit, rodent, bird and exotic pet necropsies / n° of students graduating annually	5,762	2,65	0,88	4,882	
I21*	n° of FTE specialised veterinarians involved in veterinary training / n° of students graduating annually	0,457	0,27	0,06	0,397	
I22*	n° of PhD graduating annually / n° of students graduating annually	0,421	0,15	0,07	0,351	
1	Median values defined by data from Establishments with Accreditation/Approval status in May 2019					
2	Recommended minimal values calculated as the 20th percentile of data from Establishments with Accreditation/Approval status in May 2019					
3	A negative balance indicates that the Indicator is below the recommended minimal value					
*	Indicators used only for statistical purpose					